



PROJECT

TYPE

DATE

ITEM NO.

NOTE

LED IP RATED HIGH BAY**RWUX Series**

High Bay

DESCRIPTION

The Alphalite RWUX Series Slim Round LED High Bay delivers high lumen output, long life, economic solution, and no restrike time. This energy-efficient LED luminaire offers one-to-one replacement of existing HID or fluorescent high bays. Precision-formed reflectors delivers adequate light in high mounting applications. Modular driver and LED arrays. Economic solution to optimize payback. Capable of being operated with occupancy sensor and wireless controller.

APPLICATION

Various commercial industrial applications with high ceilings: warehouse, manufacturing facilities, retail, gymnasiums, grocery.

SPECIFICATION FEATURES**Benefits**

- Attractive ROI
- Lower energy costs
- High quality light for a more productive space
- Field adjustable light output and CCT
- Field install sensor in 5 seconds

Construction

Rugged die-cast aluminum housing withstands environments without climate control. Outer surface treated with durable powder coating to provide resistance to corrosion, rust, weathering, and UV degradation. Performance-engineered, integral heat dissipation fins and LED thermal substrate provides superior thermal management for long life and reliability.

Electrical

Luminaire utilizes long life, high efficacy LEDs and a highly efficient, reliable LED driver. 6KV surge protection. Flicker percent less than 3%. Operate in humidity up to 90%. Comes equipped with quick disconnect and 6ft wire lead for compliance with US code. Built-in 3.5mm audio receptacle for sensor control.

Mounting

Comes standard equipped with threads hole for 1/2" threads stem (not provided) and attach a hook mount. Optional ring mount kit, surface mount, or add an adapter RWUX-PMK3/4 (1/2" to 3/4") for outside diameter 3/4" threads stem, stem not provided.

Optics

One piece precision molded polycarbonate. High light reflectivity reflectors. 85° beam angle comes in standard.

Finish

Outer surface treated with durable powder coating in black color to provide resistance to corrosion, rust, weathering, and UV degradation.

Certifications / Regulatory

cULus listed for wet location rated. IP65 and NEMA 4X.

Warranty

5-year limited warranty. See complete warranty terms for details.

**Quick Ship Product**

RWUX-(150/100/75)/8A
RWUX-(240/200/150)/8A
RWUX-(240/200/150)/8A-WH

ORDERING INFORMATION**Sample Number: RWUX-(150/100/75)/8A**

Series	Lumen Package		CRI	CCT	Voltage
RWUX - LED IP Rated High Bay	(150/100/75) - 150/100/75W, 22500/15000/11250lm	(240/200/150) - 240/200/150W, 36000/30000/22500lm	8 - 80+ CRI	A - Adjustable CCT (5000/4000/3500K)	(Blank) -120-347V 480 - 277-480V

Beam Angle	Lens Type	Finish	Control Option
(Blank) - 85° B120 - 120°	(Blank) - Transparent F - Frosted	(Blank) - Black WH - White	OS - Bi-level dimming PIR sensor and daylight switch, field install in 5 seconds (Required RC-100 Sensor Configuration Tool) OS-BLE - Wireless Bluetooth with PIR sensor

Emergency Backup	Accessories
EM-RM40W-GN - 40W emergency backup (Required RC-RN1 as remote control)	RWUX-RAL - Aluminium sliver Reflector cone RWUX-RPC - PC Reflector cone RWUX-SMK - adjustabel Surface Mount Kit RWUX-PMK3/4 - Pendant mount adapter for outside diameter 3/4" threads stem (Stem not provided) RWUX-WG - Wire Guard RWUX-RMK - Ring Mount Kit RWUX-NSF - NSF rated kit for food splash zone

SUMMARY

Input Voltage	120-347V
Input Frequency	50/60 Hz
Power Factor	> 0.9
THD (Max.)	< 20%
Efficacy	150 LPW
Controls/ Dimming	Full Range 0-10V dimming standard
Dimming Range	10-100%
CRI	> 80
CCT	3500/4000/5000K Selectable
Operating Temp.	-40 to +122F° (-40 to +50C°)
Rated Life	70,000 hours
IP Grade	IP65 (NEMA 4X)

ENERGY PERFORMANCE DATA

Part No.	Rated Wattage (W)	Delivered Lumens (lm)	Efficacy (lm/W)
RWUX-(150/100/75)/8A	150/100/75	22500/15000/11250	150
RWUX-(240/200/150)/8A	240/200/150	36000/30000/22500	150

OPTICS

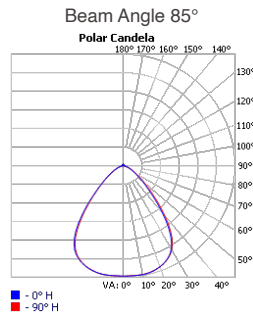

PHYSICAL PARAMETERS

DIMENSION

RWUX-(150/100/75)

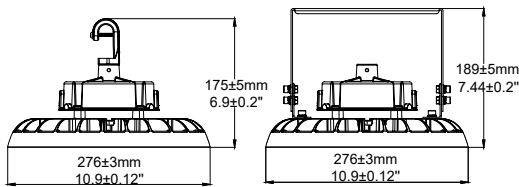

RWUX-(240/200/150)

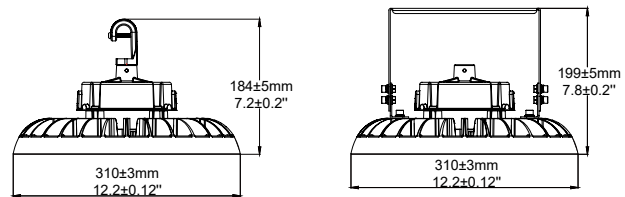

MOUNTING OPTION

RWUX-RMK



RWUX-SMK



RWUX-PMK3/4



REFLECTOR OPTION

RWUX-RAL



RWUX-RPC



CONTROL OPTION

RWUX-WG

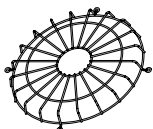

Emergency Backup

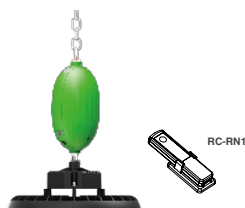

Sensor & Controller

OS:MMS-DC-PIR4T
OS-BLE: MMS-PIR4T-BLE-SR

