



PROJECT

TYPE

DATE

ITEM NO.

NOTE

**LED IP RATED HIGH BAY****RWUX Series**

High Bay

**DESCRIPTION**

The AlphaLite RWUX Series Slim Round LED High Bay delivers high lumen output, long life, economic solution. This energy-efficient LED luminaire offers one-to-one replacement of existing HID or fluorescent high bays. Precision-formed reflectors delivers adequate light in high mounting applications. Modular driver and LED arrays. Economic solution to optimize payback. Capable of being operated with occupancy (PIR an Microwave) sensor.

**APPLICATION**

Various commercial industrial applications with high ceilings: warehouse, manufacturing facilities, retail, gymnasiums, grocery.

**SPECIFICATION FEATURES****Benefits**

- Attractive ROI
- Lower energy costs
- High quality light for a more productive space
- Field adjustable light output and CCT
- Field install sensor in 5 seconds

**Construction**

Rugged die-cast aluminum housing withstands environments without climate control. Outer surface treated with durable powder coating to provide resistance to corrosion, rust, weathering, and UV degradation. Performance-engineered, integral heat dissipation fins and LED thermal substrate provides superior thermal management for long life and reliability.

**Electrical**

Luminaire utilizes long life, high efficacy LEDs and a highly efficient, reliable LED driver. Standard with 6ft wire lead. 120-347V input voltage for increased versatility. Comes equipped with quick disconnect for compliance with US code.

**Mounting**

Comes standard equipped with threads hole for 1/2" threads stem (not provided) and attach a hook mount. Optional ring mount kit, surface mount, or add an adapter RWUX-PMK3/4 (1/2" to 3/4") for outside diameter 3/4" threads stem, stem not provided.

**Optics**

One piece precision molded polycarbonate. High light reflectivity reflectors. 90° beam angle comes in standard.

**Finish**

Outer surface treated with durable powder coating in black color to provide resistance to corrosion, rust, weathering, and UV degradation.

**Certifications / Regulatory**

cULus listed. IP65 and NEMA 4X.

**Warranty**

7-year limited warranty. See complete warranty terms for details.

**Quick Ship Product**

RWUX-(150/100/75)/8A  
RWUX-(240/200/150)/8A  
RWUX-(240/200/150)/8A-WH

**ORDERING INFORMATION****Sample Number: RWUX-(150/100/75)/8A**

Series		Lumen Package			CRI
RWUX - LED IP Rated High Bay	(150/100/75)	(240/200/150)	(300/240/200)	8 - 80+ CRI	
	-150/100/75W, 22500/15000/11250lm	-240/200/150W, 36000/30000/22500lm	-300/240/200W, 45000/36000/30000lm		
CCT	Voltage	Beam Angle	Lens Type	Color	Control Option
A - Adjustable CCT (5000/4000/3500K)	(Blank) - 120-347V 480 - 277-480V	(Blank) - 90° B120 - 120°	(Blank) - Transparent F - Frosted	(Blank) - Black WH - White	MMS-DC-PIR4T - PIR motion sensor and daylight sensor, field install in 5 seconds (Required RC-100 Sensor Configuration Tool) MMS-DC4T - Microwave motion sensor and daylight sensor, field install in 5 seconds (Required RC-100 Sensor Configuration Tool)
EM Option		Assembly in Mexico	Accessories		
EM-RM40W-GN - 40W emergency backup (Required RC-RN1 as remote control)		TAA -Assembly in Mexico	RWUX-RAL - Aluminium sliver Reflector cone RWUX-RPC - PC Reflector cone RWUX-SMK - adjustabel Surface Mount Kit	RWUX-PMK3/4 - Pendant mount adapter for 3/4" NPT threads (Stem not provided) RWUX-WG - Wire Guard RWUX-RMK - Ring Mount Kit RWUX-NSF - NSF rated kit for food splash zone	

## SUMMARY

Input Voltage	120-347V
Input Frequency	50/60 Hz
Power Factor	> 0.9
THD (Max.)	< 20%
Efficacy	150 LPW
Controls/ Dimming	Full Range 0-10V dimming standard
Dimming Range	10-100%
CRI	> 80
CCT	3500/4000/5000K Selectable
Operating Temp.	-22°F to +122°F (-30°C to +50°C)
Rated Life	70,000 hours
IP Grade	IP65 (NEMA 4X)

## ENERGY PERFORMANCE DATA

Part No.	Rated Wattage (W)	Delivered Lumens (lm)	Efficacy (lm/W)
RWUX-(150/100/75)/8A	150/100/75	22500/15000/11250	150
RWUX-(240/200/150)/8A	240/200/150	36000/30000/22500	150
RWUX-(300/240/200)/8A	300/240/200	45000/36000/30000	150

\*The delivered lumens above are based on highest wattage and 4000K.

\*\*Default setting at time of shipping are highest wattage and highest CCT.

## PHYSICAL PARAMETERS

### DIMENSION

RWUX-(150/100/75)

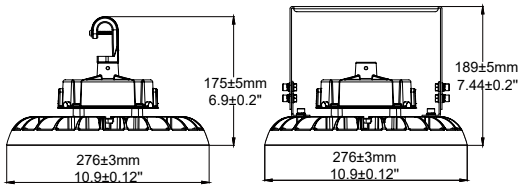

RWUX-(240/200/150)

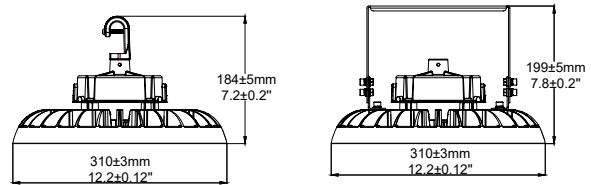

RWUX-(300/240/200)

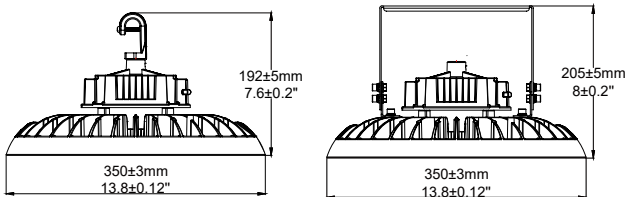

## MOUNTING OPTION

RWUX-RMK



RWUX-SMK



RWUX-PMK3/4



## REFLECTOR OPTION

RWUX-RAL



RWUX-RPC



## CONTROL OPTION

RWUX-WG

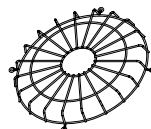

Emergency Backup



Sensor

