



PROJECT

TYPE

DATE

ITEM NO.

NOTE

LED TRADITIONAL WALL PACK

WPTA-P3 Series

Wall Luminaires

DESCRIPTION

The WPTA-P3 Series LED Traditional wall pack is a integrated LED solution that delivers long life and energy savings. The heavy duty cast aluminum housing offers advanced thermal management and protection against outdoor environments without compromising aesthetics.

APPLICATION

AlphaLite WPTA-P3 Series are ideal for brightly-lit outdoor wall mount applications in parking garages, entrances, public areas, schools, hospitals, hotels and outdoor walkways that demand long service life and low maintenance.

SPECIFICATION FEATURES

Construction

Heavy duty die-cast aluminum housing withstands outdoor environments. Outer surface treated with durable polyester powder coating to provide resistance to corrosion, rust, weathering, and UV degradation. Performance-engineered, integral heat dissipation provides superior thermal management for long life and reliability. Housing and optics maintain IP65 rating with all internal components including optional integrated sensor. 4KV Surge protection come in standard.

Mounting

Luminaire mounting designed for standard J-Box. Can be mounted directly to surface. Features multiple 1/2 NPS knockouts.conduit entries.

Optics

High-quality shatter-resistant lenses optimize performance and increase delivered light to desired areas.



Electrical

Luminaire utilizes long life, high efficacy LEDs and reliable LED driver. 120V-277V input voltage for increased versatility. Comes equipped with quick disconnect for compliance with US code. 0-10V dimming available.

Controls

Suitable for use with photocell and High/Low/Off microwave fixture-integrated motion sensor to achieve deeper energy-savings and code compliance.

Finish

Outer surface treated with durable dark bronze powder coating to provide resistance to corrosion, rust, weathering, and UV degradation.

Certifications / Regulatory

UL listed. IP65 rating. All components have safety approvals.

Warranty

7-year limited warranty. See complete warranty terms for details.

Quick Ship Product

WPTA-P335/830
WPTA-P335/840
WPTA-P335/850

WPTA-P350/830
WPTA-P350/840
WPTA-P350/850

WPTA-P375/830
WPTA-P375/840
WPTA-P375/850

WPTA-P375/830-10V
WPTA-P375/840-10V
WPTA-P375/850-10V

ORDERING INFORMATION

Sample Number: **WPTA-P375/850**

WPTA-P3	75	850	(Blank)	(Blank)	(Blank)	(Blank)
Series	Lumen Package	CCT	Input Voltage	Dimming	Beam Angle	Finish Color
WPTA-P3 - LED	35 - 35W	830 - 3000K	(Blank) -	(Blank) - Non-	(Blank) - Type III	(Blank) - Dark Bronze
Traditional Wall Pack	50 - 50W	840 - 4000K	120V-277V	dimmable		
	75 - 75W	850 - 5000K		10V - 0-10V		
	100 - 100W					
	120 - 120W					
	*See energy data for details					

Options

Accessories

DSS - Dark Sky Shield

Controls

MMS - Step dimming microwave motion sensor

PS - Photocell Switch

Emergency Backup

(Lumen will maintain over the 90-minute duration)

EM700 - 700lm *

EM1400 - 1400lm *

*Testing button placed inside of fixture

SUMMARY

Input Voltage	100V-277V
Input Power	See energy data for details
Power Factor	> 0.95
THD (Max.)	20%
Efficacy	> 135 LPW
Delivered Lumens	See energy data for details
Controls/ Dimming	0-10V dimming
CRI	> 80
CCT	3000K, 4000K, 5000K
Operating Temp.	-40°F ~ 120°F (-40°C ~ +48°C)
Rated Life	70,000 hours
IP Grade	IP65
BUG Rating	B1-U4-G4 for 40W, B2-U4-G5 for 60W, B2-U5-G5 for 80W & 100W, and B3- U5-G5 for 120W

ENERGY PERFORMANCE DATA

Part No.	Rated Wattage (W)	Delivered Lumens (lm)	Efficacy (lm/W)
WPTA-P335/830	35	4725	135
WPTA-P335/840		4725	135
WPTA-P335/850		4725	135
WPTA-P350/830	50	6750	135
WPTA-P350/840		6750	135
WPTA-P350/850		6750	135
WPTA-P375/830	75	10125	135
WPTA-P375/840		10125	135
WPTA-P375/850		10125	135
WPTA-P3100/830	100	13500	135
WPTA-P3100/840		13500	135
WPTA-P3100/850		13500	135
WPTA-P3120/830	120	16200	135
WPTA-P3120/840		16200	135
WPTA-P3120/850		16200	135

*The delivered lumens above are based on highest wattage and 4000K.

**Default setting at time of shipping are highest wattage and highest CCT.

DARK SKY SHIELD

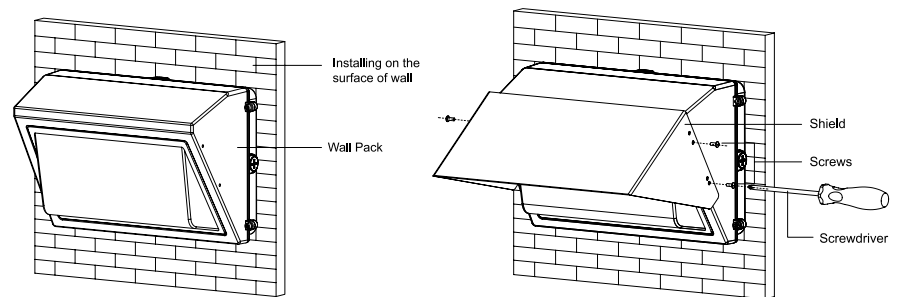

PHYSICAL PARAMETERS

DIMENSION

WPTA-P335, 50 and 75

WPTA-P335: 8.09 Lbs
WPTA-P350: 8.49 Lbs
WPTA-P375: 8.93 Lbs

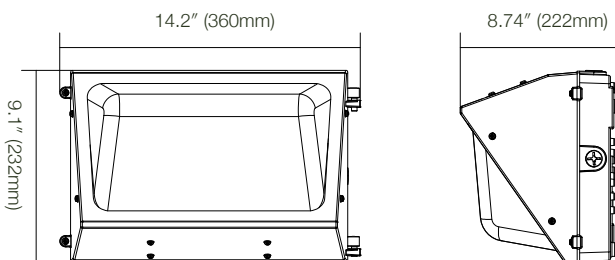

WPTA-P3100 and 120

14.44 Lbs

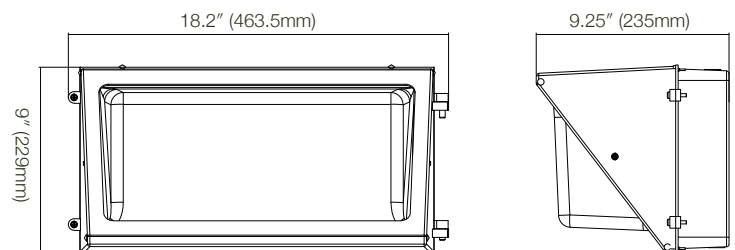

-DMMS/MMS control pre-commissioning**Sample Number: -MMS (5-3M-L3-S10M)**

10	3M	L3	S10M	(Blank)	
Detection Area	Hold Time	Low Mode	Stand-by Period	Daylight Sensor	
5 - 50%	20M - 20 min.	L5 - 50%	SN - ∞	(Blank) - Disable	
1 - 10%	3M - 3 min.	L3 - 30%	S1H - 1 hr.	D100 - 100 lux	
	90S - 90 sec.	L2 - 20%	S30M - 30 min.	D50 - 50 lux	
	30S - 30 sec.	L1 - 10%	S10M - 10 min.	D25 - 25 lux	
	5S - 5 sec.		S5M - 5 min.	D10 - 10 lux	
	N - ∞		S5S - 5 sec.	D5 - 5 lux	
			(Blank) - Disable	D2 - 2 lux	
<p>Detection Area: Detection area can be reduced to fit precisely each application.</p> <p>Hold Time: The time period the luminaire remains at 100% illumination after no motion detected.</p> <p>Low Mode: The selected low light level after the hold time.</p> <p>Stand-by Period: The time period the luminaire remains at "Low Mode" before it completely switched off in the long absence of people.</p> <p>When set to "∞" mode, the low light level is maintained until motion is detected.</p> <p>Daylight Sensor: The sensor can be set to only allow the luminaire to illuminate below a defined ambient brightness threshold.</p> <p>When set to "Disable" mode, the daylight sensor will switch on the luminaire when motion is detected regardless of ambient light level.</p> <p>**Noted that daylight sensor is active only when the luminaire switches off**</p>					