

Installation Instructions

Blade one LED Linear

ILB-2L(20W)/9A

ILB-3H(40A)/9A

ILB-4H(40A)/9A



WARNING Risk of Fire and Electric Shock.

The luminaire must be installed by a qualified electrician in accordance with applicable federal, state, and local laws and codes. Installation requires knowledge of luminaire electrical systems and installer should be familiar with the operation of this product. If not qualified, do not attempt installation; contact a qualified electrician. Manufacturer assumes no responsibility for the improper installation of this luminaire. When installing the fixture, drilling may damage luminaire wiring and electrical parts. Check for wiring and components in enclosure before drilling. Turn OFF power before installation or attempting any maintenance.

To prevent wiring damage or abrasion, do not expose wiring to edges of sheet metal or other sharp objects. When installing this kit, drilling may damage luminaire wiring and electrical parts. Check for wiring and components in enclosure before drilling.



WARNING Risk of Burn.

Disconnect power and allow fixture to cool before handling or servicing.



WARNING Risk of Personal Injury.

Wear gloves or proper handling protection to prevent cuts or abrasions when handling and maintaining this product. This equipment may have sharp edges. To reduce the risk of death, personal injury or property damage from fire, electric shock, falling parts, cuts/abrasions, and other hazards read all warning and instructions included with and on the fixture box and all fixture labels. Avoid direct eye exposure to the light source while it is on.

NOTICE

- Green ground screw provided in proper location. Do not relocate.
- Minimum 90°C supply conductors.
- Suitable for Dry or Damp location.
- Specifications and dimensions subject to change without notice.



Contact manufacturer with any questions or concerns regarding installation of this luminaire.

Alphalite

Installation Instructions

Blade one LED Linear

Suspension Mount

► Connect the power cord

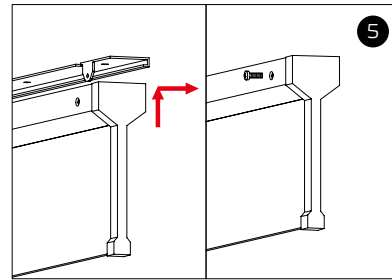
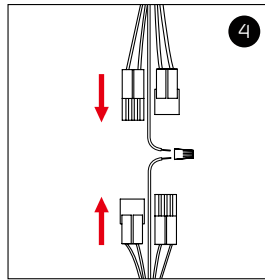
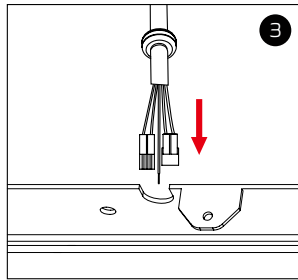
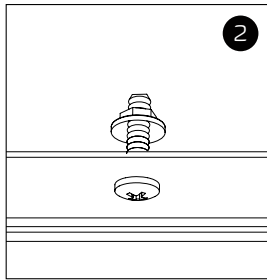
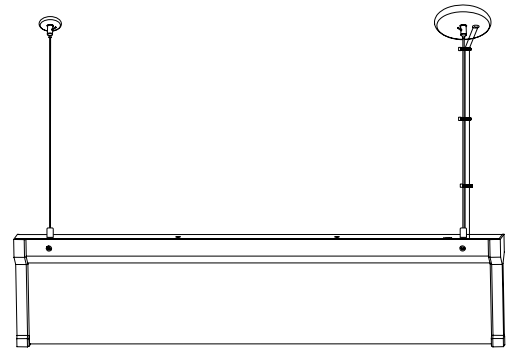
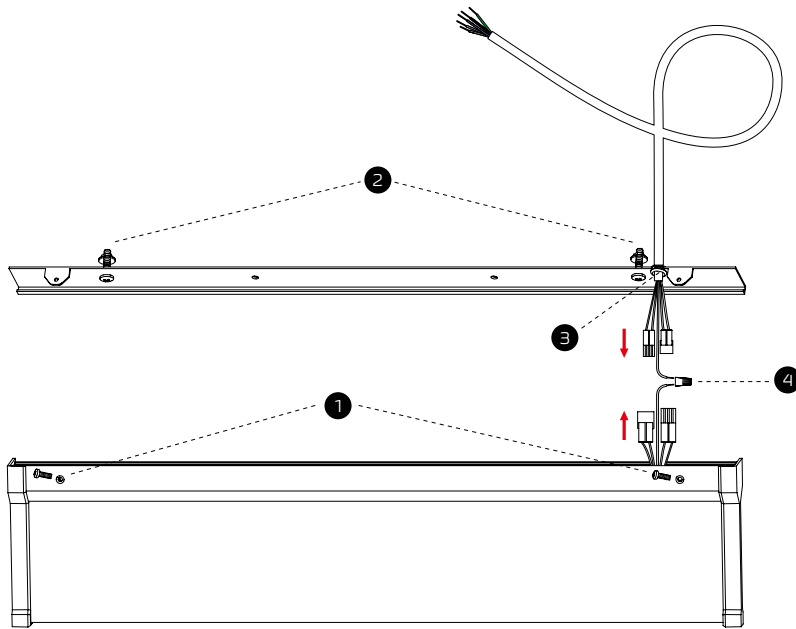

PLEASE FOLLOW THESE STEPS

- 1 Take off the cover by screwdriver.
(Please noted that there are screws&screwnuts inside the luminaire).
- 2 Assemble the screws&screwnuts as shown.
- 3 Insert the power cord into the opening of cover as shown.
- 4 Connect wires by quick connectors and wiring caps.
- 5 Reattach the cover by using provided into the led luminaire.
- 6 Suspend the led luminaire in the ceiling

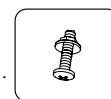

Screw &
Screwnut

* Different ceiling type use corresponding accessory as below.

Alphalite

Installation Instructions

Blade one LED Linear

Suspension Mount

► Install the mounting kit for Drywall Ceiling

► POWER FEED

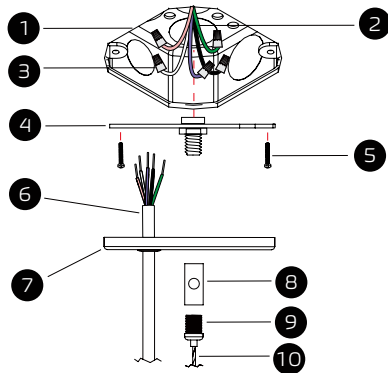

► NON POWER SUSPENSION

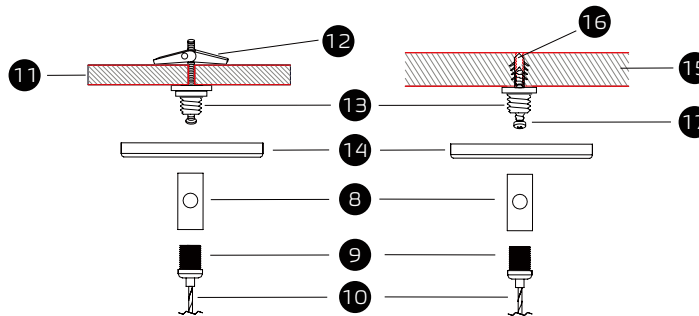

► PARTS LIST

- 1 4" Octagon Junction Box (By Others)
- 2 Power Cord (By Others)
- 3 Wire Nut
- 4 Junction Box Crossbar
- 5 Screw PM4*22
- 6 Power Cord
- 7 4" Power Canopy Kit
- 8 Cable Holder
- 9 Strain Relief Thread Nut
- 10 Aircraft Cable
- 11 Drywall Ceiling (By Others)
- 12 Butterfly Drywall Anchor
- 13 Crimp Stud
- 14 2" Canopy
- 15 Solid Ceiling (By Others)
- 16 Anchor
- 17 Screw PA4*30

Canopy

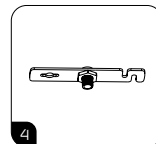

Junction Box Crossbar

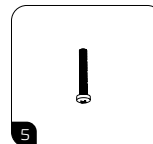

Screw PM4*22

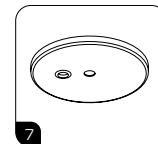

4" Canopy Power Feed

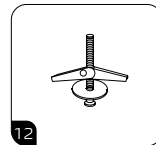

Butterfly Drywall Anchor

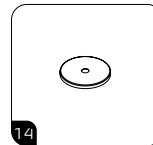

2" or 4" Canopy

Power Cord

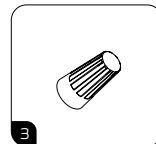

Wire Nut

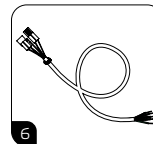

Power Cord

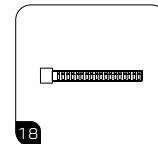

Cable Tie

Suspension Kit

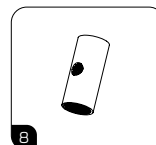

Cable Holder

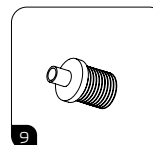

Strain Relief Thread Nut

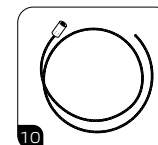

Aircraft Cable

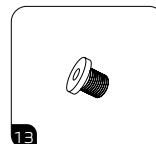

Crimp Stud

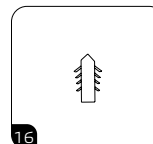

Anchor

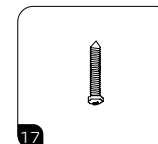

Screw PA4*30

Alphalite

Installation Instructions

Blade one LED Linear

Suspension Mount

► Install the mounting kit for Drop Ceiling

►► POWER FEED

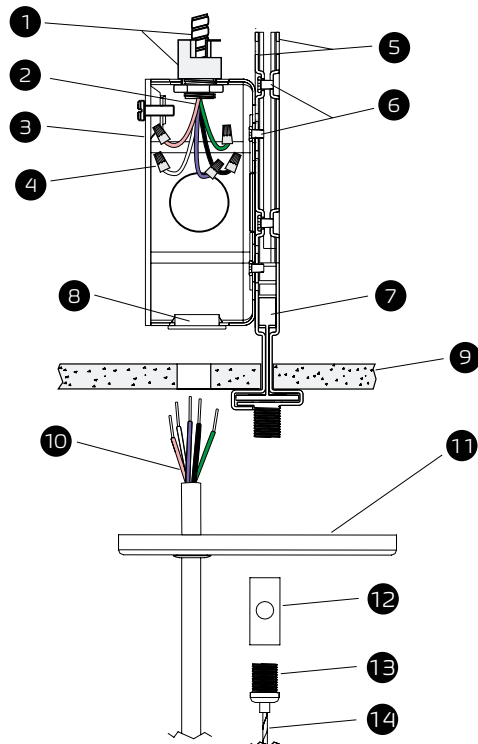

►► NON POWER SUSPENSION

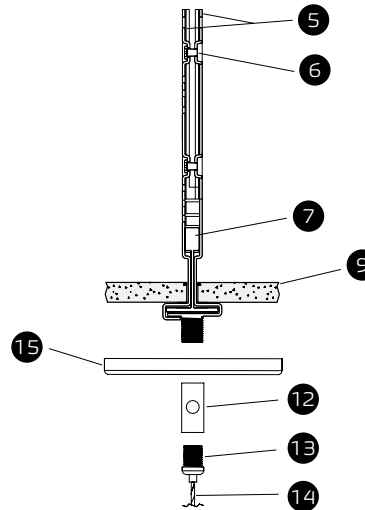

Junction BOX

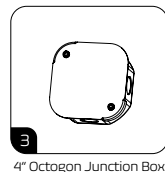

4" Octagon Junction Box

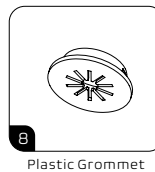

Plastic Grommet

T-grid Clips

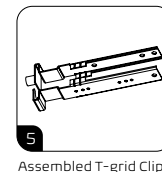

Assembled T-grid Clips



Screw 6#*4

Power Cord

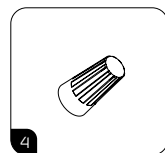

Wire Nut

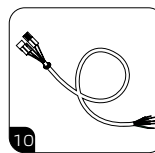

Power Cord

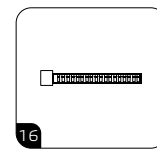

Cable Tie

Canopy

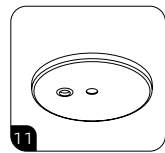

4" Canopy Power Feed

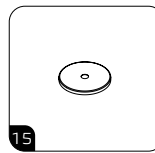

2" or 4" Canopy

Suspension Kit

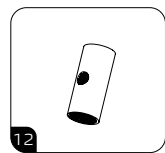

Cable Holder

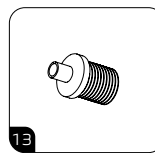

Strain Relief Thread Nut

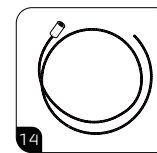

Aircraft Cable

►► PARTS LIST

- 1 Armored Cable & Connector (By Others)
- 2 Power Cord (By Others)
- 3 4" Octagon Junction Box
- 4 Wire Nut
- 5 Assembled T-grid Clips
- 6 Screw 6#*4
- 7 T-grid (By Others)
- 8 Plastic Grommet
- 9 Ceiling Tile (By Others)
- 10 Power Cord
- 11 4" Canopy Power Feed
- 12 Cable Holder
- 13 Strain Relief Thread Nut
- 14 Aircraft Cable
- 15 2" Canopy

Alphalite

Installation Instructions

Blade one LED Linear

Surface Mount

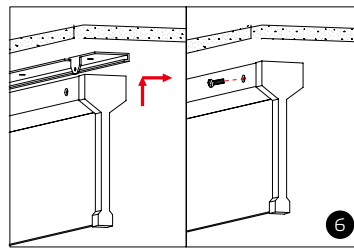
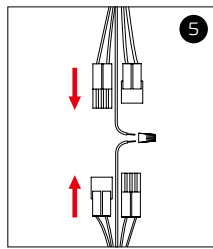
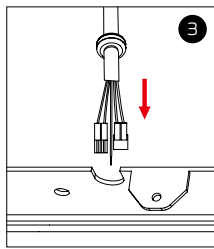
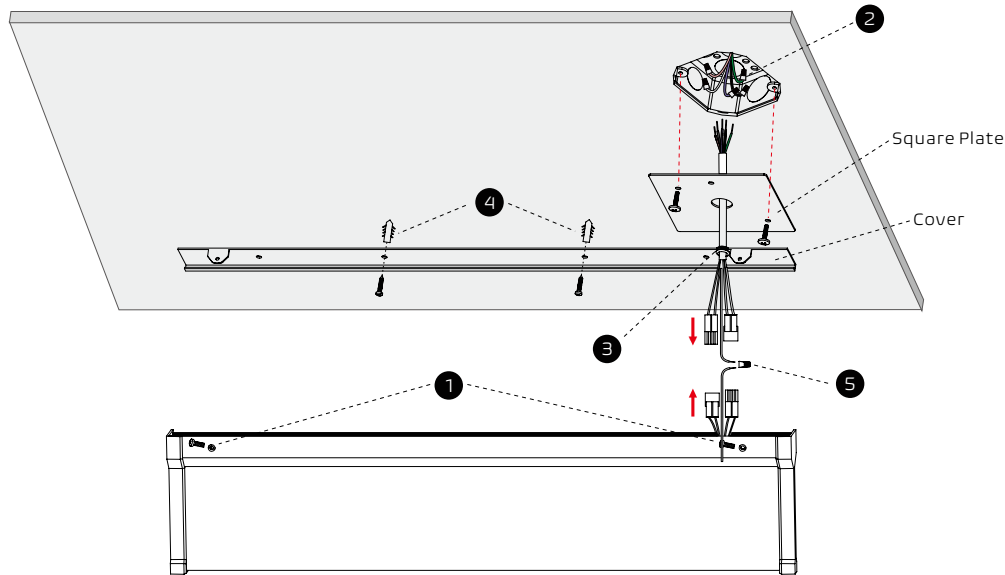

PLEASE FOLLOW THESE STEPS

- 1 Take off the cover by screwdriver.
- 2 Connect the wires of power cable (provided) with junction box by the wiring caps. Cover the junction box with square plate and fix it with screws, then plaster.
- 3 Insert the power cord into the opening of cover as shown.
- 4 Fix the cover in the ceiling.

Ceiling Type

Solid Ceiling (By Others)



Hole Diameter: 0.20"

Drywall Ceiling (By Others)

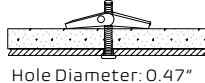

Hole Diameter: 0.47"

Mounting Point

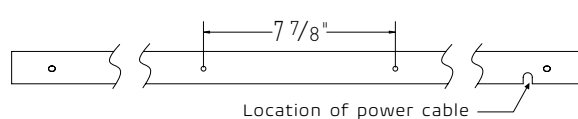

ACCESSORY

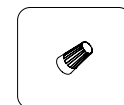

Wire Nut



Anchor



Screw PA4X30

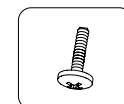

Screw CM4X12

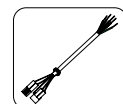

Power Cord

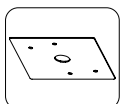

Square Plate

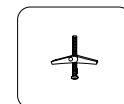

Butterfly
Drywall
Anchor

- 5 Connect wires by quick connectors and wiring caps, then hide all wires into the junction box.
- 6 Fix led luminaire on the cover with screws.

Alphalite

Installation Instructions

Blade one LED Linear

Wall Mount

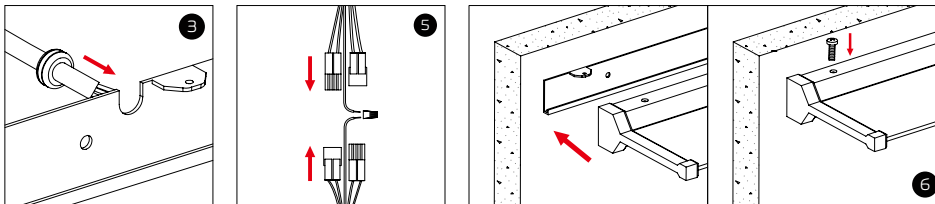
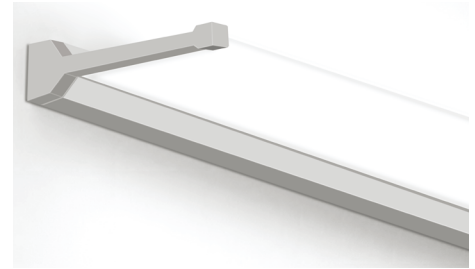
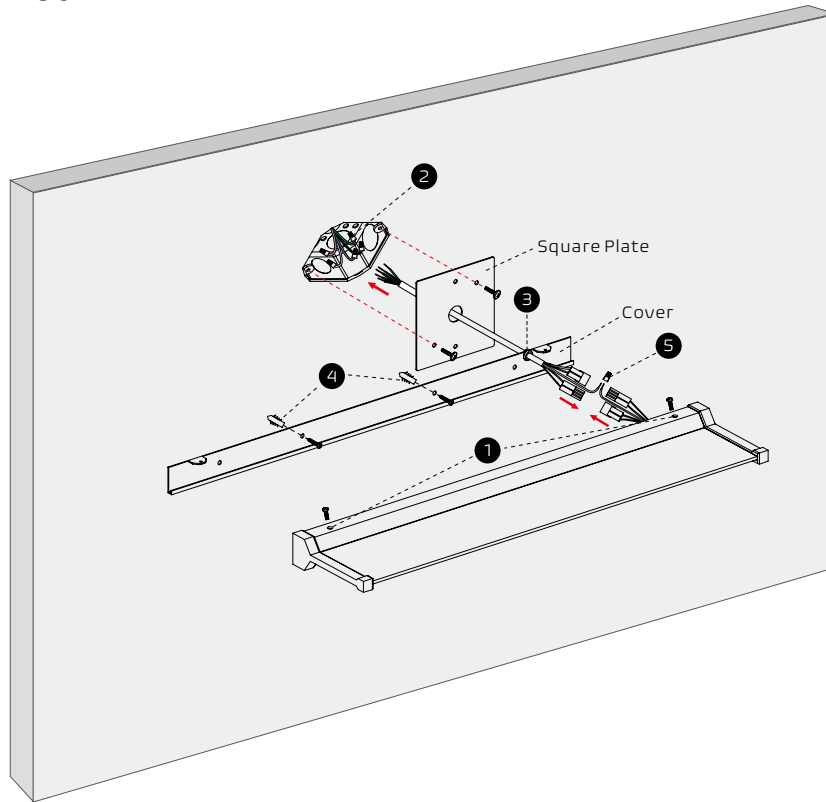

INSTALLATION STEPS

- 1 Take off the cover by screwdriver.
- 2 Connect the wires of power cable (provided) with junction box by the wiring caps.
Cover the junction box with square plate and fix it with screws, then plaster.
- 3 Insert the power cord into the opening of cover as shown.
- 4 Fix the cover in the ceiling.

Ceiling Type



Hole Diameter: 0.20"

Mounting Point

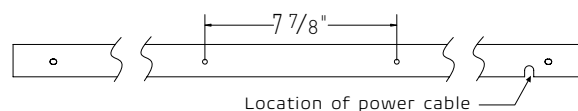

Location of power cable

- 5 Connect wires by quick connectors and wiring caps, then hide all wires into the junction box.
- 6 Fix led luminaire on the cover with screws.

ACCESSORY

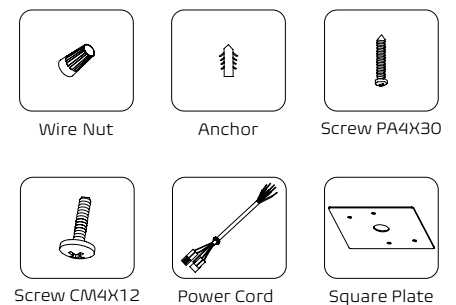

Alphalite