



PROJECT

TYPE

DATE

ITEM NO.

NOTE

LED IP RATED HIGH BAY

RWUX Series

High Bay

DESCRIPTION

The Alphalite RWUX Series Slim Round LED High Bay delivers high lumen output, long life, economic solution. This energy-efficient LED luminaire offers one-to-one replacement of existing HID or fluorescent high bays. Precision-formed reflectors delivers adequate light in high mounting applications. Modular driver and LED arrays. Economic solution to optimize payback. Capable of being operated with occupancy (Bluetooth, PIR an Microwave) sensor.

APPLICATION

Various commercial industrial applications with high ceilings: warehouse, manufacturing facilities, retail, gymnasiums, grocery.

SPECIFICATION FEATURES

Benefits

- Attractive ROI
- Lower energy costs
- High quality light for a more productive space
- Field Adjustable Light Output and CCT (FALO, FACT)
- Controls Ready, field install sensor in 5 seconds

Construction

Rugged die-cast aluminum housing withstands environments without climate control. Outer surface treated with durable powder coating to provide resistance to corrosion, rust, weathering, and UV degradation. Performance-engineered, integral heat dissipation fins and LED thermal substrate provides superior thermal management for long life and reliability.

Electrical

Luminaire utilizes long life, high efficacy LEDs and a highly efficient reliable LED driver. Standard with 6ft wire lead. 120-347V input voltage for increased versatility.



Mounting

Comes standard equipped with treads hole for 1/2" threads stem and attach a hook mount. Optional ring mount kit, surface mount, or add an adapter for outside diameter 3/4" threads stem.

Optics

One piece precision molded polycarbonate. High light reflectivity reflectors. 90° beam angle comes in standard, 120° optional.

Finish

Outer surface treated with durable powder coating in black color to provide resistance to corrosion, rust, weathering, and UV degradation.

Certifications / Regulatory

cULus listed for wet locations. IP65 and NEMA 4X. RoHS compliant. DLC 6.0 listed.

Warranty

7-year limited warranty. See complete warranty terms for details.

Quick Ship Product

RWUX-(150/100/75)/8A
 RWUX-(240/200/150)/8A
 RWUX-(240/200/150)/8A-WH

ORDERING INFORMATION

Sample Number: RWUX-(150/100/75)/8A

Series	Lumen Package			CRI	CCT	Voltage
RWUX - LED IP Rated High Bay	(150/100/75) -150/100/75W, 22500/15000/11250lm	(240/200/150) -240/200/150W, 36000/30000/22500lm	(300/240/200) -300/240/200W, 45000/36000/30000lm	8 - 80+ CRI	A - Adjustable CCT (5000/4000/3500K)	(Blank) - 120-347V 480 - 277-480V

Beam Angle	Lens Type	Color	Control Option	EM Option
(Blank) - 90° B120 - 120°	(Blank) - Transparent F - Frosted	(Blank) - Black WH - White	MMS-DC-PIR4T (-BK) - Bi-level dimming PIR motion sensor and daylight switch. Default white and available in black color option. (Required RC-100 sensor configuration Tool) MMS-DC4T - Bi-level dimming Microwave motion sensor and daylight switch (Required RC-100 sensor configuration tool) MMS-PIR4T-BLE-SR (-BK) - Wireless Bluetooth mesh and PIR sensor. Default white and available in black color option	EM-RM40W-GN - 40W emergency backup (Required remote control RC-RN1)

Assembly in Mexico	Accessories	
TAA -Assembly in Mexico	RWUX-RAL - Aluminium sliver reflector cone for 100-240W RWUX-RAL-300W - Aluminium sliver reflector cone for 300W RWUX-RPC - PC reflector cone for for 100-240W RWUX-RPC-300W - PC reflector cone for 300W RWUX-PMK3/4(-BK/WH) - Pendant mount adapter for 3/4" NPT threads (Stem not provided)	RWUX-SMK(-BK/WH) - Adjustabel surface mount Kit RWUX-WG - Wire guard for 100-240W RWUX-WG-300W - Wire guard for 300W RWUX-RMK(-BK/WH) - Ring mount Kit RWUX-NSF(-BK/WH) - NSF rated kit for food splash zone

SUMMARY

Input Voltage	120-347V
Input Frequency	50/60 Hz
Power Factor	> 0.9
THD (Max.)	< 20%
Efficacy	150 LPW
Controls/ Dimming	Full Range 0-10V dimming standard
Dimming Range	10-100%
CRI	> 80
CCT	3500/4000/5000K Selectable
Operating Temp.	-22°F to +122°F (-30°C to +50°C)
Rated Life	70,000 hours
IP Grade	IP65 (NEMA 4X)

ENERGY PERFORMANCE DATA

Part No.	Rated Wattage (W)	Delivered Lumens (lm)	Efficacy (lm/W)
RWUX-(150/100/75)/8A	150/100/75	22500/15000/11250	150
RWUX-(240/200/150)/8A	240/200/150	36000/30000/22500	150
RWUX-(300/240/200)/8A	300/240/200	45000/36000/30000	150

*The delivered lumens above are based on highest wattage and 4000K.
 **Default setting at time of shipping are highest wattage and highest CCT.

OPTICS

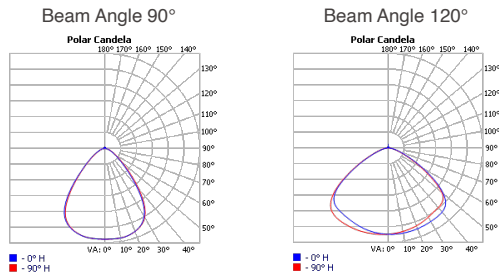

PHYSICAL PARAMETERS

DIMENSION

RWUX-(150/100/75)

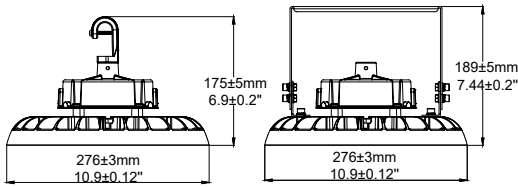

RWUX-(240/200/150)

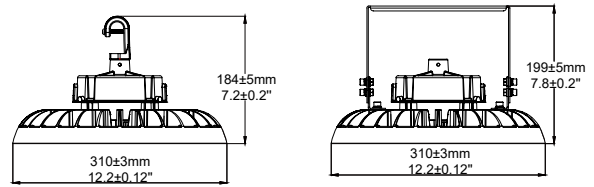

RWUX-(300/240/200)

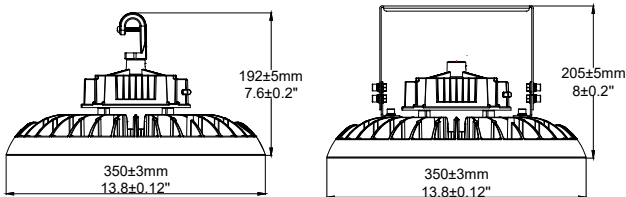

MOUNTING OPTION

RWUX-RMK



RWUX-SMK



RWUX-PMK3/4



REFLECTOR OPTION

RWUX-RAL



RWUX-RPC



CONTROL OPTION

RWUX-WG



Emergency Backup



Sensor

MMS-DC-PIR4T
MMS-DC-PIR4T-BLE-SR

MMS-DC4T

